

Instruction for patients,

Chlamydia and gonorrhoea testing for a person with vagina

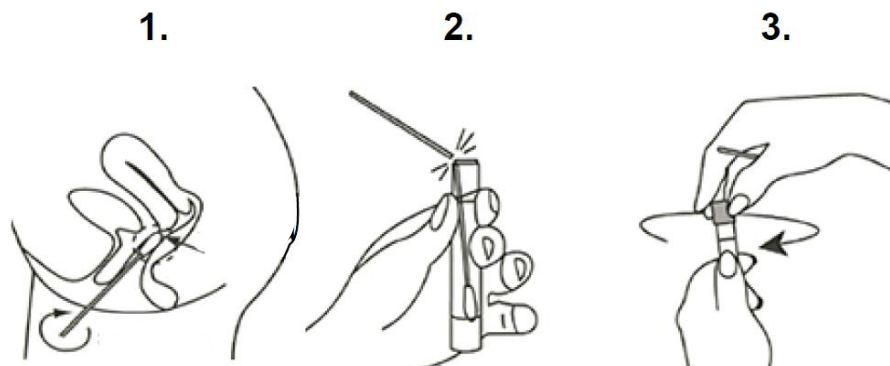

1. Unscrew the lid of the tube.
Take the cotton swab and insert it 2 inches (5 cm) into the vagina.
Rotate the swab on the sides of the vagina for approximately 30 seconds.
2. Place the swab in the test tube with the cotton bud downwards - break the shaft of the swab at the marked point.
3. Screw on the lid of tube and make sure it is secure. Place the tube in the specified place.

